



1 Isis House, Abingdon Road, Oxford, OX1 4LD

Property Particulars

Type: Ground Floor Apartment

Bedrooms: 1

Furnishing: Part furnished

Location: Off Abingdon Road, a few minutes walking distance to the City Centre

Views: All windows overlook the River Thames

Interior:

Living Area: Open plan living and kitchen area

Kitchen: Integrated with living area

Bedroom: Double bedroom

Bathroom: En-suite shower room

Additional Information:

Council Tax: Band B

Viewing: Highly recommended

- 1 Bedroom
- 1 Reception
- 1 Bathroom
- South Oxford

£1,400 PCM

GROUND FLOOR

APPROX. 31.9 SQ. METRES (343.5 SQ. FEET)

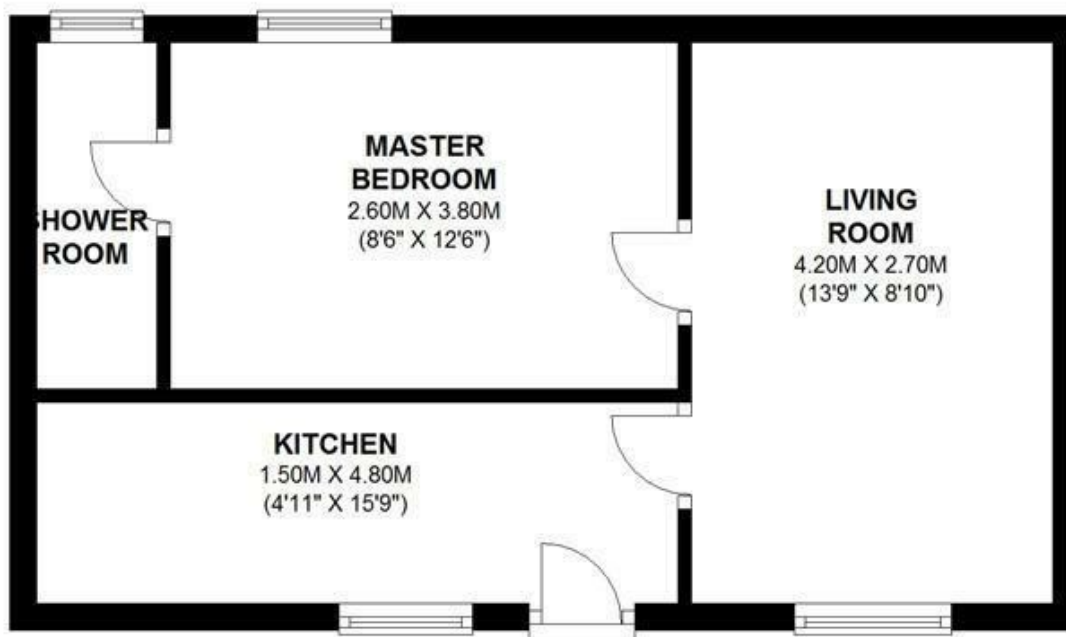

TOTAL AREA: APPROX. 31.9 SQ. METRES (343.5 SQ. FEET)

Energy Efficiency Rating		
	Current	Potential
Very energy efficient - lower running costs		
(92 plus) A		
(81-91) B		
(69-80) C		
(55-68) D		
(39-54) E		
(21-38) F		
(1-20) G		
Not energy efficient - higher running costs		
	44	68
England & Wales		
EU Directive 2002/91/EC		

Environmental Impact (CO ₂) Rating		
	Current	Potential
Very environmentally friendly - lower CO ₂ emissions		
(92 plus) A		
(81-91) B		
(69-80) C		
(55-68) D		
(39-54) E		
(21-38) F		
(1-20) G		
Not environmentally friendly - higher CO ₂ emissions		
	50	56
England & Wales		
EU Directive 2002/91/EC		